

# BILL OF BEARINGS 10 800 ROADWAY WIDTH - 3 SPAN

No.	LOCATION	DESCRIPTION	REMARKS
54	SU.1 - SU.4	Elastomeric bearings	As detailed

**NOTE:**  
 1. Elastomer shall be natural rubber. Elastomer shall be AASHTO low temperature Grade 5 with a minimum shear modulus  $G \geq 0.9 \text{ MPa}$  and a 60 durometer Shore A hardness.  
 2. Internal steel reinforcing plates for laminate bearings shall be rolled mild steel conforming to CAN/CSA G40.21 with a minimum yield strength of 300 MPa.

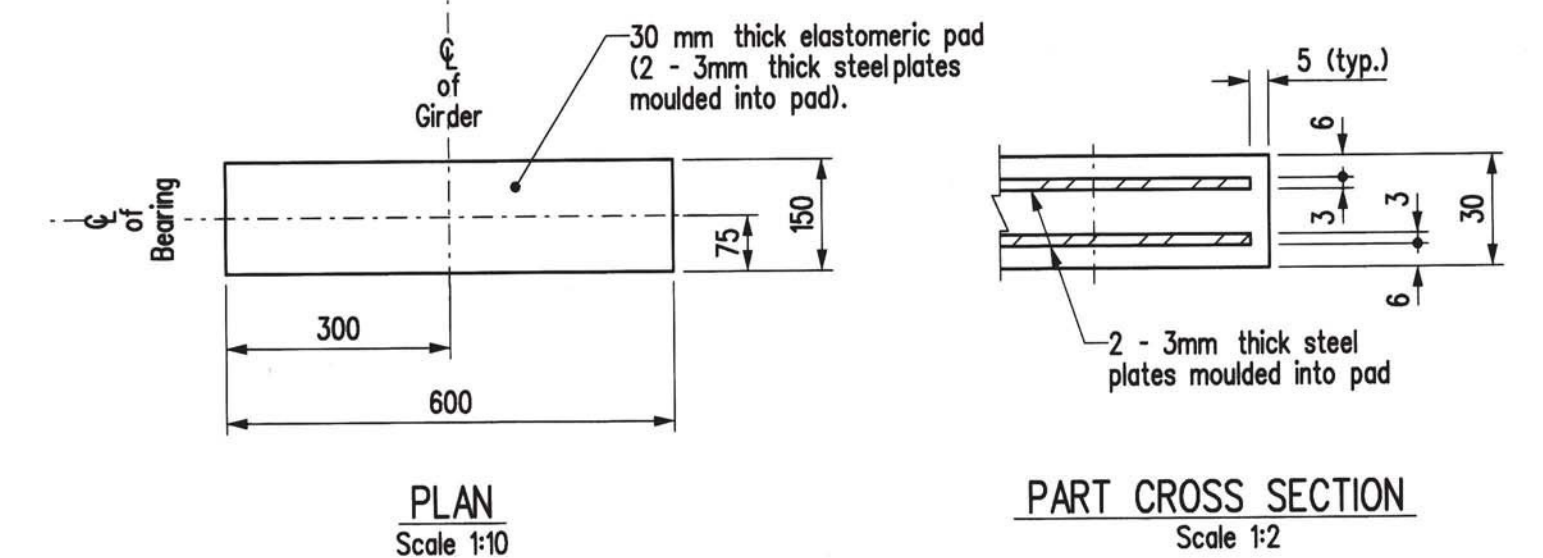

**ELASTOMERIC BEARINGS**

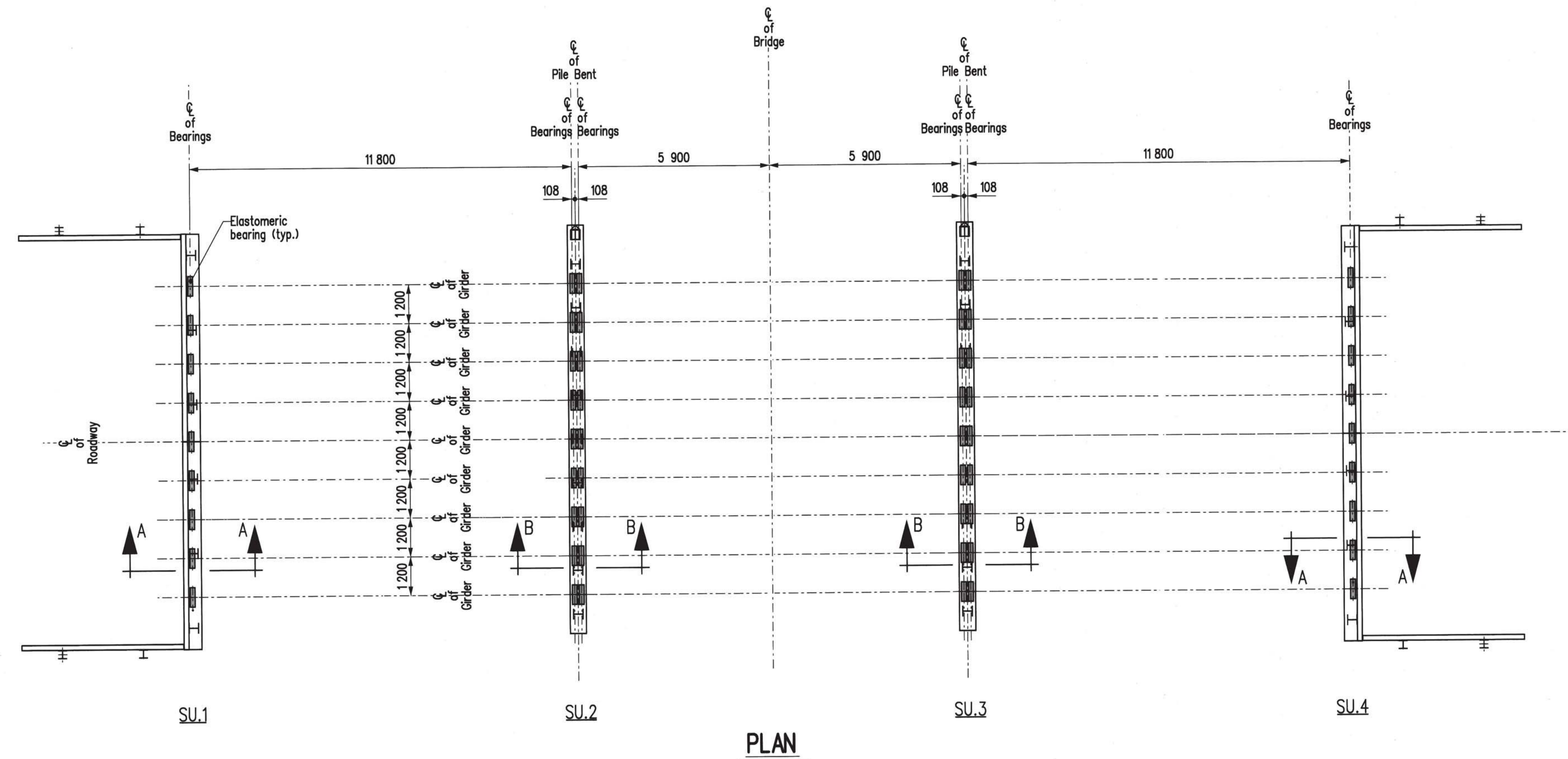

**PLAN**

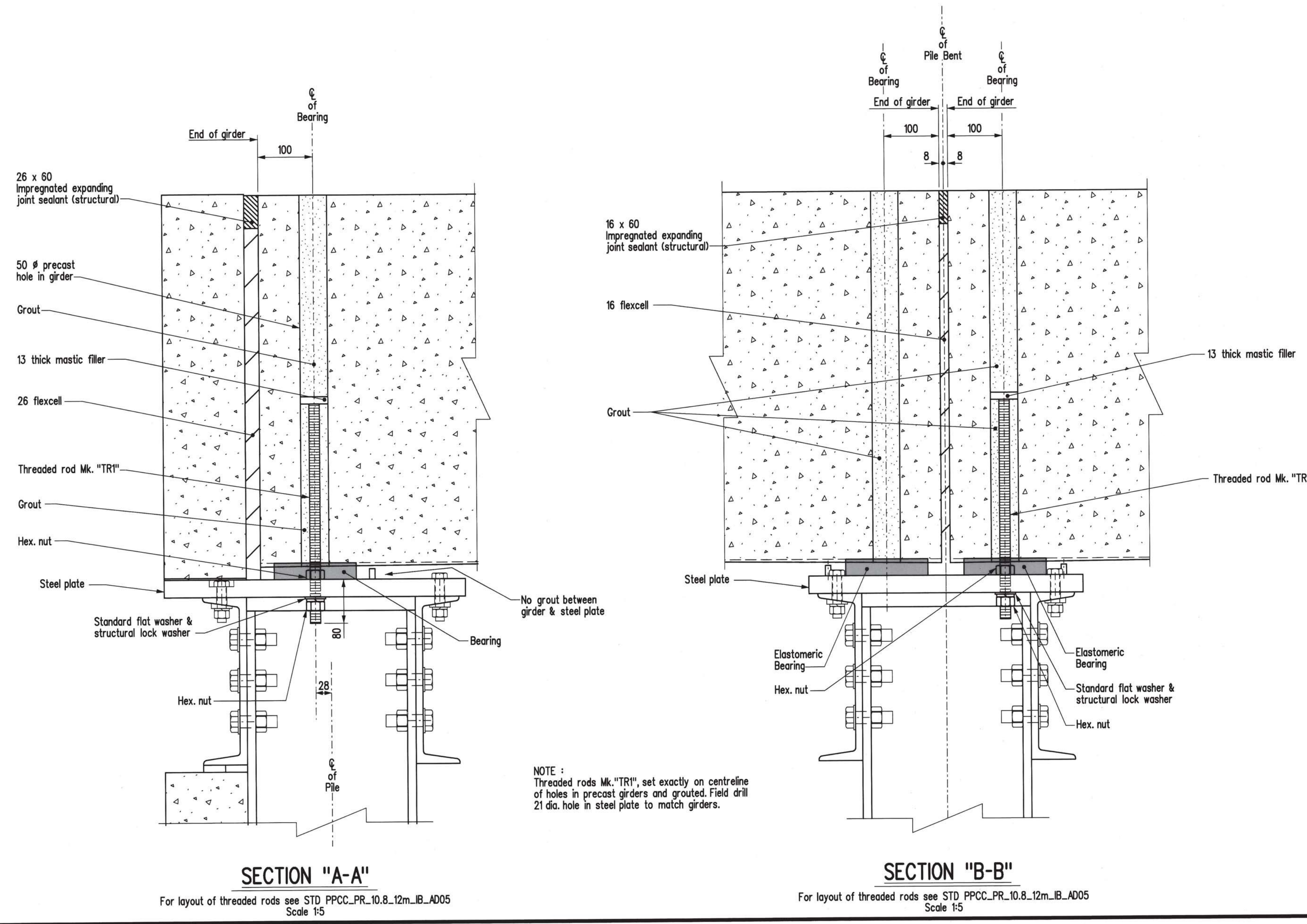

**SECTION "A-A"**

For layout of threaded rods see STD PPCC\_PR\_10.8\_12m\_IB\_AD05 Scale 1:5

**SECTION "B-B"**

For layout of threaded rods see STD PPCC\_PR\_10.8\_12m\_IB\_AD05 Scale 1:5

- NOTES:**  
 Re: Girder Erection Operations Behind Abutment Ballast Walls  
 1. Surcharge loading on the backfill resulting from girder erection operations shall be minimized near the precast concrete ballast walls and wingwalls.  
 2. Where possible, girder erection equipment shall be positioned such that there are no surcharge loads behind the back face of the precast panels within a distance equal to the depth of backfill to the bottom of the panels at the time of girder erection.  
 3. Should the Contractor propose to encroach on this zone, the following requirements must be satisfied:  
 - Submit a girder erection procedure for approval outlining type, configuration, weights and locations of equipment including expected tipping forces on crane outriggers, etc.  
 - Perform all precautionary measures outlined by the Department as a result of that submission.  
 - All surcharge loads encroaching in this zone must be distributed over an area not less than 2.0 m<sup>2</sup>.

REVISIONS		BEARING AND ERECTION DETAILS	
DATE	BY	DESCRIPTION	APPROVED BY:
			Original signed by Michael Hagos July 28, 2020
			DIRECTOR OF STRUCTURES
			DATE
			SCALE:
			1:100
			SHEET No.
			OR AS SHOWN
			STD No. PPCC_PR_10.8_12m_IB_BE03
			DESIGN
			BY: A.H.P.
			CHECKED: A.H.P.
			DETAILS
			BY: K.P./N.J.
			CHECKED: A.H.P.