

CLASS 2 SOIL	
CLASS 3 SOIL	
CLASS 4 SOIL	
CLASS 5 SOIL	
CLASS 6 SOIL	
CLASS 7 SOIL	
WATER	

LEGEND	
MUNICIPAL BORDER	
SUBJECT SITE	
EXISTING WATER FEATURE	
PROVINCIAL ROAD	
GOVERNMENT ROAD ALLOWANCE	
SPREADFIELD	
SUBJECT SITE	

NO.	DATE	APP.	BY	DESCRIPTION
REVISIONS				

PRELIMINARY

FOR REVIEW AND COMMENT ONLY

DESIGNED BY: KD  
 REVIEWED BY: DB  
 DRAWN BY: VP  
 PROJECT START DATE: DEC, 2023  
 PLOT SIZE: A1 (594x841)  
 SCALE: AS NOTED

PROJECT NAME:  
**NORWOOD COLONY**  
**NEW SITE DEVELOPMENT**  
**RM OF ST. ANDREWS**

**BURNS MAENDEL**  
 CONSULTING ENGINEERS LTD.

903 Rosser Ave.  
 Brandon, Manitoba  
 R7A 0R4  
 Tel: (204) 728-7364  
 Fax: (204) 728-4418

DRAWING TITLE:  
**SPREADFIELDS**

PROJECT NUMBER: **BMCE-23-001**  
 DRAWING NO: **SK-1**

Rge. 3E.

Twp. 18

Twp. 17

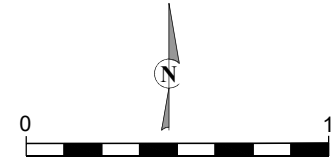
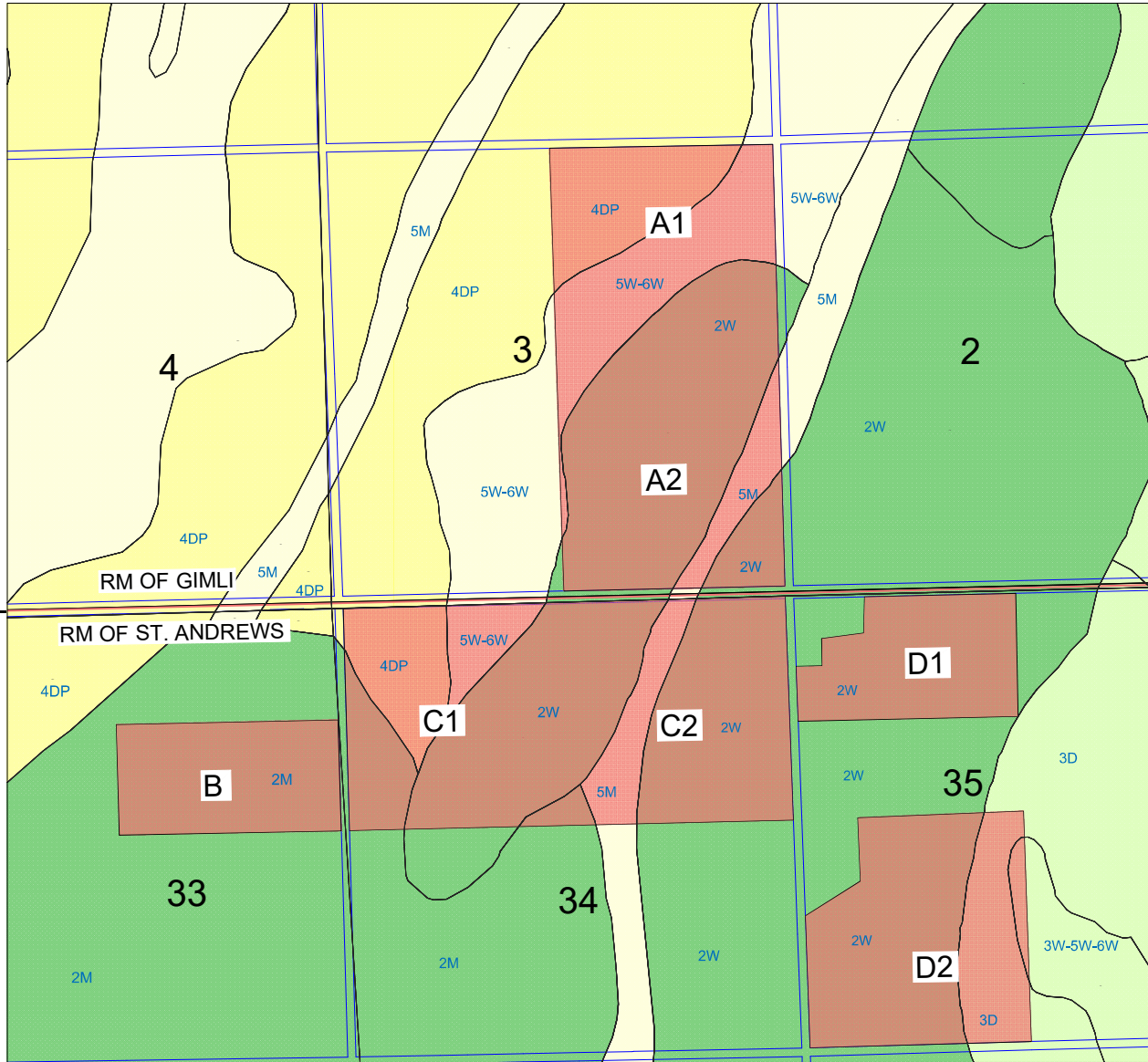

SCALE IN KILOMETRES

CLASS 2 SOIL	
CLASS 3 SOIL	
CLASS 4 SOIL	
CLASS 5 SOIL	
CLASS 6 SOIL	
CLASS 7 SOIL	
WATER	

LEGEND	
MUNICIPAL BORDER	
SUBJECT SITE	
EXISTING WATER FEATURE	
PROVINCIAL ROAD	
GOVERNMENT ROAD ALLOWANCE	
SPREADFIELD	
SUBJECT SITE	

**PRELIMINARY**  
FOR REVIEW AND COMMENT ONLY

NO.	DATE	APP.	BY	DESCRIPTION
REVISIONS				

DESIGNED BY KD	REVIEWED BY DB
DRAWN BY VP	
PROJECT START DATE DEC, 2023	
PLOT SIZE A1 (594x841)	
SCALE AS NOTED	

PROJECT NAME:  
**NORWOOD COLONY  
NEW SITE DEVELOPMENT  
RM OF ST. ANDREWS**

903 Rosser Ave.  
Brandon, Manitoba  
R7A 0R4  
Tel: (204) 728-7364  
Fax: (204) 728-4418

DRAWING TITLE: <b>SPREADFIELDS VIEWPORT 1</b>	PROJECT NUMBER: BMCE-23-001	DRAWING NO: SK-1A
--	--------------------------------	----------------------

Rge. 3E.

Twp. 17

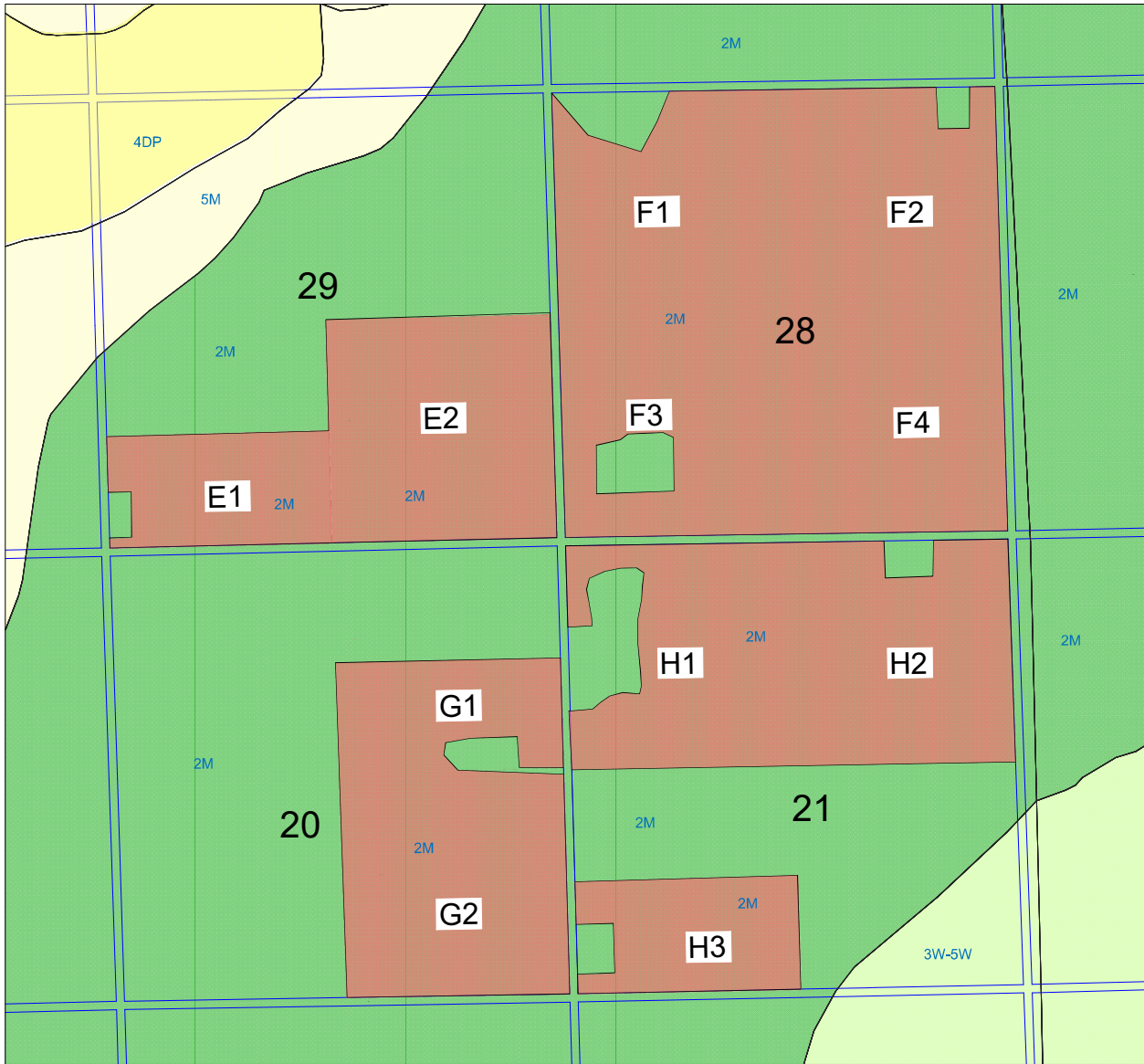

CLASS 2 SOIL	
CLASS 3 SOIL	
CLASS 4 SOIL	
CLASS 5 SOIL	
CLASS 6 SOIL	
CLASS 7 SOIL	
WATER	

LEGEND	
MUNICIPAL BORDER	
SUBJECT SITE	
EXISTING WATER FEATURE	
PROVINCIAL ROAD	
GOVERNMENT ROAD ALLOWANCE	
SPREADFIELD	
SUBJECT SITE	

**PRELIMINARY**  
FOR REVIEW AND COMMENT ONLY

NO.	DATE	APP.	BY	DESCRIPTION
REVISIONS				

DESIGNED BY: KD	REVIEWED BY: DB	PROJECT NAME: NORWOOD COLONY NEW SITE DEVELOPMENT RM OF ST. ANDREWS	DRAWING TITLE: SPREADFIELDS VIEWPORT 2
DRAWN BY: VP	PROJECT START DATE: DEC, 2023	<b>BURNS MAENDEL</b> CONSULTING ENGINEERS LTD. 903 Rosser Ave. Brandon, Manitoba R7A 0R4 Tel: (204) 728-7364 Fax: (204) 728-4418	PROJECT NUMBER: BMCE-23-001
PLOT SIZE: A1 (594x841)	SCALE: AS NOTED		DRAWING NO: SK-1B

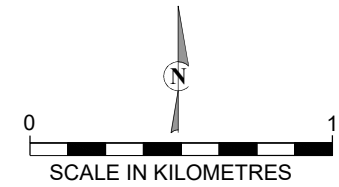
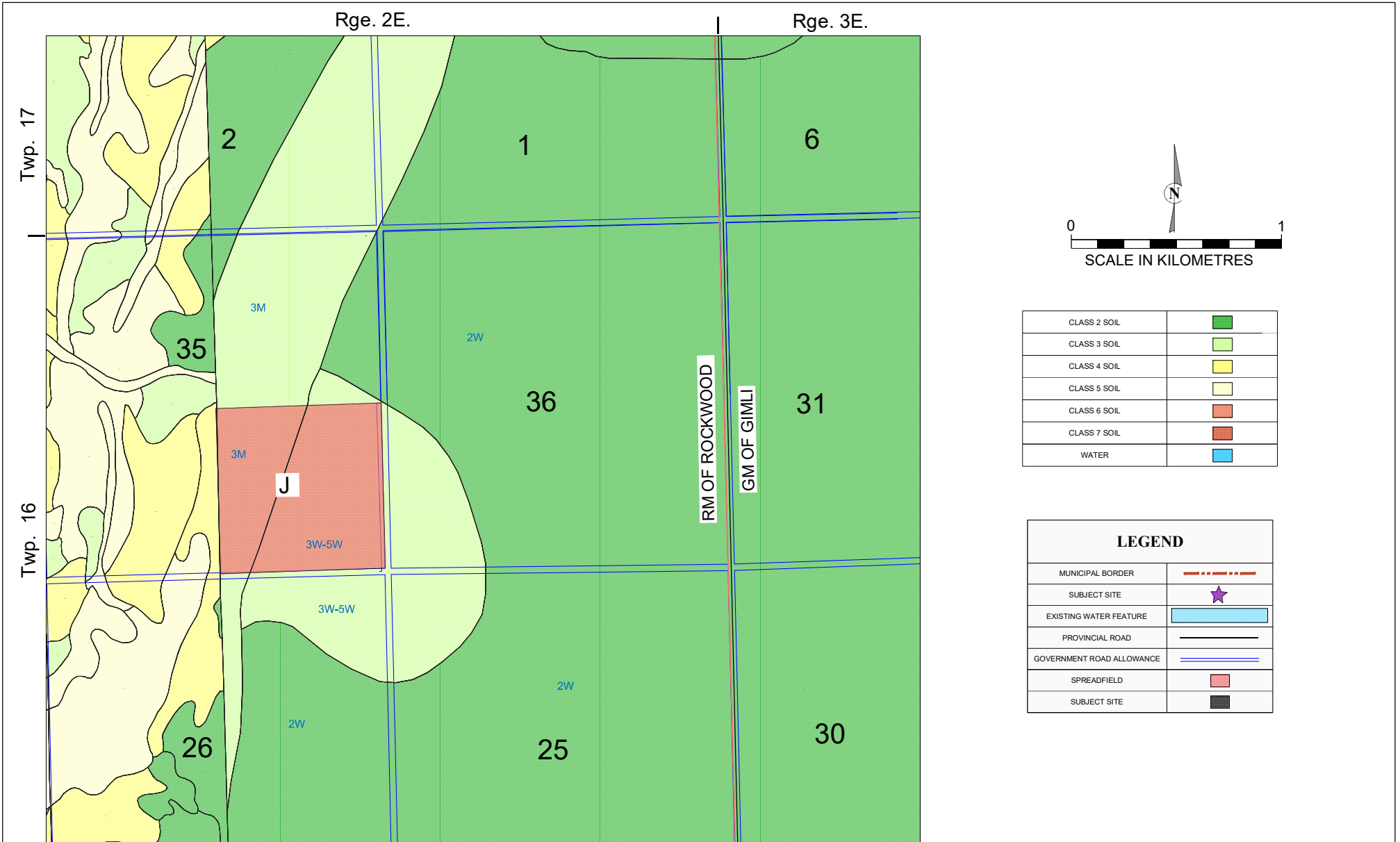

CLASS 2 SOIL	
CLASS 3 SOIL	
CLASS 4 SOIL	
CLASS 5 SOIL	
CLASS 6 SOIL	
CLASS 7 SOIL	
WATER	

LEGEND	
MUNICIPAL BORDER	
SUBJECT SITE	
EXISTING WATER FEATURE	
PROVINCIAL ROAD	
GOVERNMENT ROAD ALLOWANCE	
SPREADFIELD	
SUBJECT SITE	

NO.	DATE	APP.	BY	DESCRIPTION
REVISIONS				

**PRELIMINARY**  
FOR REVIEW AND COMMENT ONLY

DESIGNED BY: KD	REVIEWED BY: DB
DRAWN BY: VP	
PROJECT START DATE: DEC, 2023	
PLOT SIZE: A1 (594x841)	
SCALE: AS NOTED	

PROJECT NAME: NORWOOD COLONY  
NEW SITE DEVELOPMENT  
RM OF ST. ANDREWS

903 Rosser Ave.  
Brandon, Manitoba  
R7A 0R4  
Tel: (204) 728-7364  
Fax: (204) 728-4418

DRAWING TITLE: SPREADFIELDS VIEWPORT 3	PROJECT NUMBER: BMCE-23-001	DRAWING NO: SK-1C
--	-----------------------------	-------------------

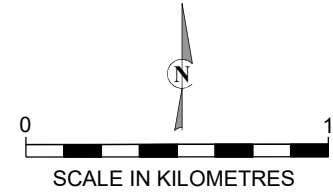
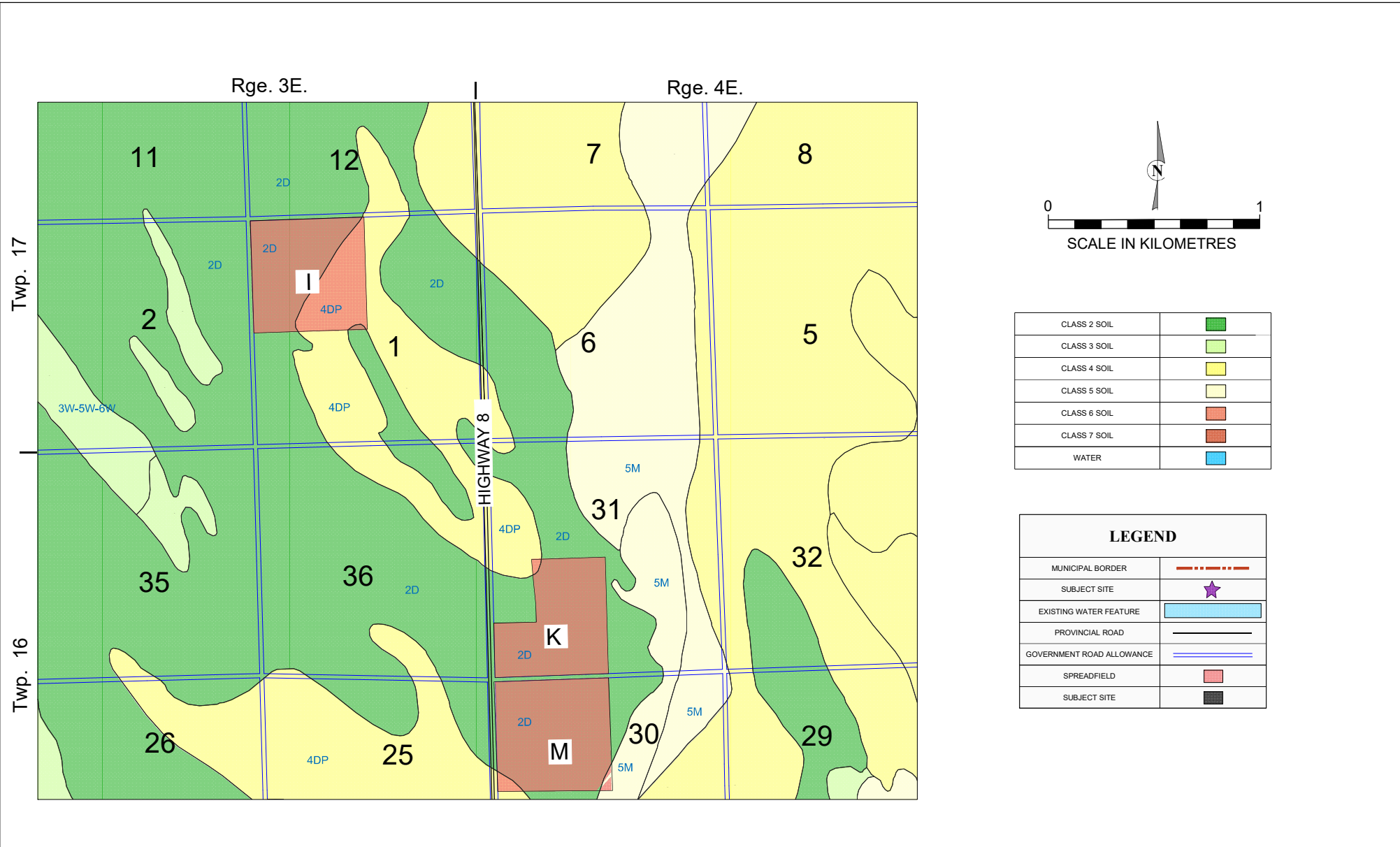

CLASS 2 SOIL	
CLASS 3 SOIL	
CLASS 4 SOIL	
CLASS 5 SOIL	
CLASS 6 SOIL	
CLASS 7 SOIL	
WATER	

LEGEND	
MUNICIPAL BORDER	
SUBJECT SITE	
EXISTING WATER FEATURE	
PROVINCIAL ROAD	
GOVERNMENT ROAD ALLOWANCE	
SPREADFIELD	
SUBJECT SITE	

NO.	DATE	APP.	BY	DESCRIPTION
REVISIONS				

PRELIMINARY

FOR REVIEW AND COMMENT ONLY

DESIGNED BY KD	REVIEWED BY DB
DRAWN BY VP	
PROJECT START DATE: DEC, 2023	
PLOT SIZE: A1 (594x841)	
SCALE: AS NOTED	

PROJECT NAME:  
**NORWOOD COLONY  
 NEW SITE DEVELOPMENT  
 RM OF ST. ANDREWS**

**BURNS MAENDEL**  
 CONSULTING ENGINEERS LTD.

903 Rosser Ave.  
 Brandon, Manitoba  
 R7A 0R4  
 Tel: (204) 728-7364  
 Fax: (204) 728-4418

DRAWING TITLE: <b>SPREADFIELDS VIEWPORT 4</b>	
PROJECT NUMBER: <b>BMCE-23-001</b>	DRAWING NO: <b>SK-1D</b>

Rge. 3E.

Twp. 16

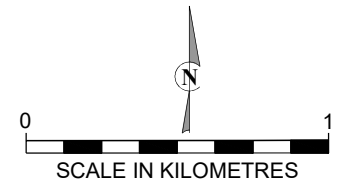
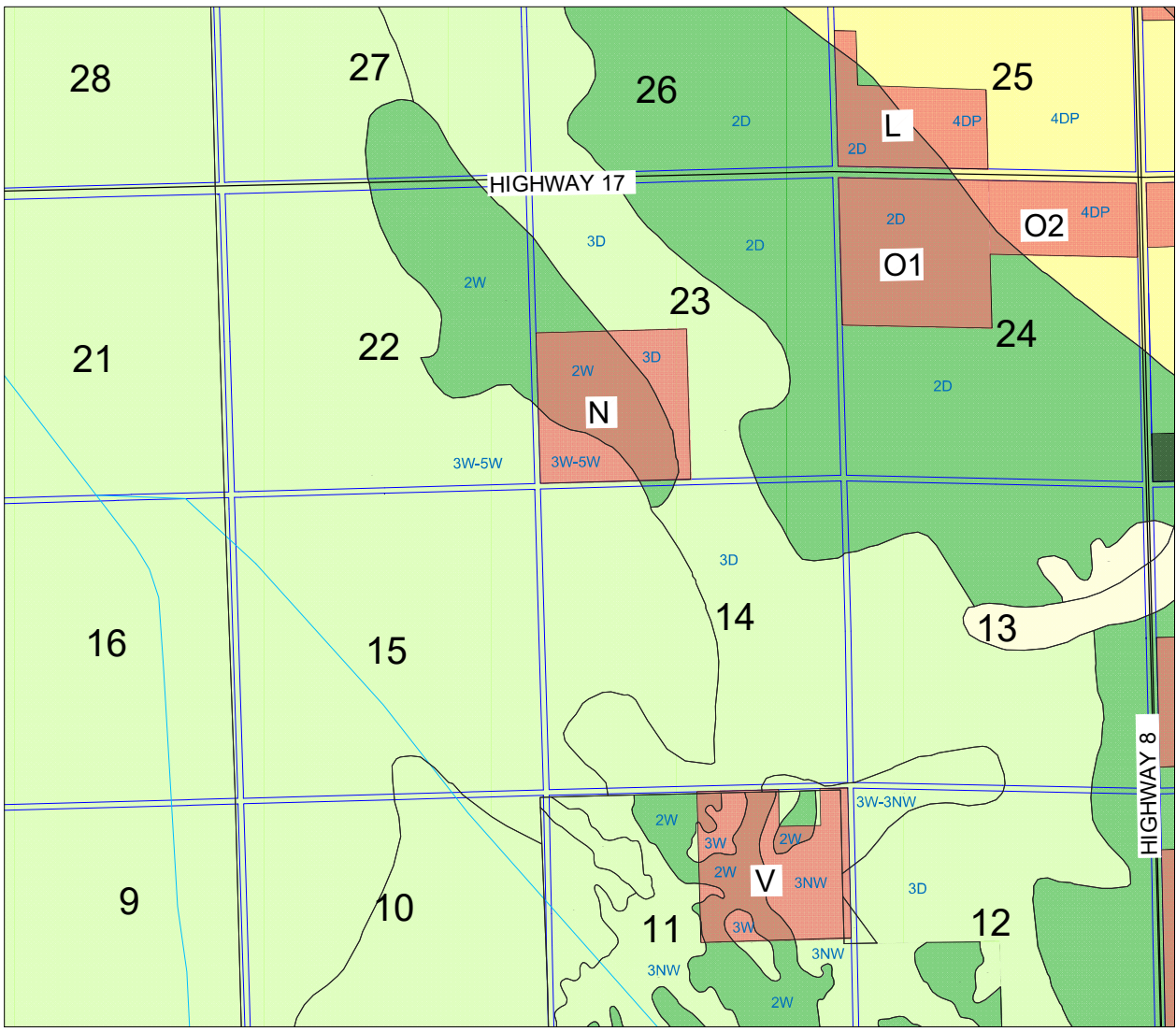

CLASS 2 SOIL	
CLASS 3 SOIL	
CLASS 4 SOIL	
CLASS 5 SOIL	
CLASS 6 SOIL	
CLASS 7 SOIL	
WATER	

LEGEND	
MUNICIPAL BORDER	
SUBJECT SITE	
EXISTING WATER FEATURE	
PROVINCIAL ROAD	
GOVERNMENT ROAD ALLOWANCE	
SPREADFIELD	
SUBJECT SITE	

NO.	DATE	APP.	BY	DESCRIPTION
REVISIONS				

**PRELIMINARY**  
FOR REVIEW AND COMMENT ONLY

DESIGNED BY KD	REVIEWED BY DB
DRAWN BY VP	
PROJECT START DATE DEC, 2023	
PLOT SIZE A1 (594x841)	
SCALE AS NOTED	

PROJECT NAME:  
**NORWOOD COLONY  
 NEW SITE DEVELOPMENT  
 RM OF ST. ANDREWS**

903 Rosser Ave.  
 Brandon, Manitoba  
 R7A 0R4  
 Tel: (204) 728-7364  
 Fax: (204) 728-4418

DRAWING TITLE: <b>SPREADFIELDS VIEWPORT 5</b>	
PROJECT NUMBER: BMCE-23-001	DRAWING NO: SK-1E

Rge. 4E.

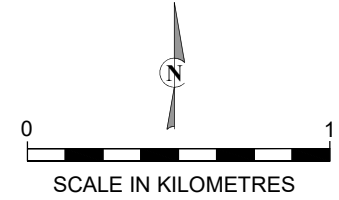
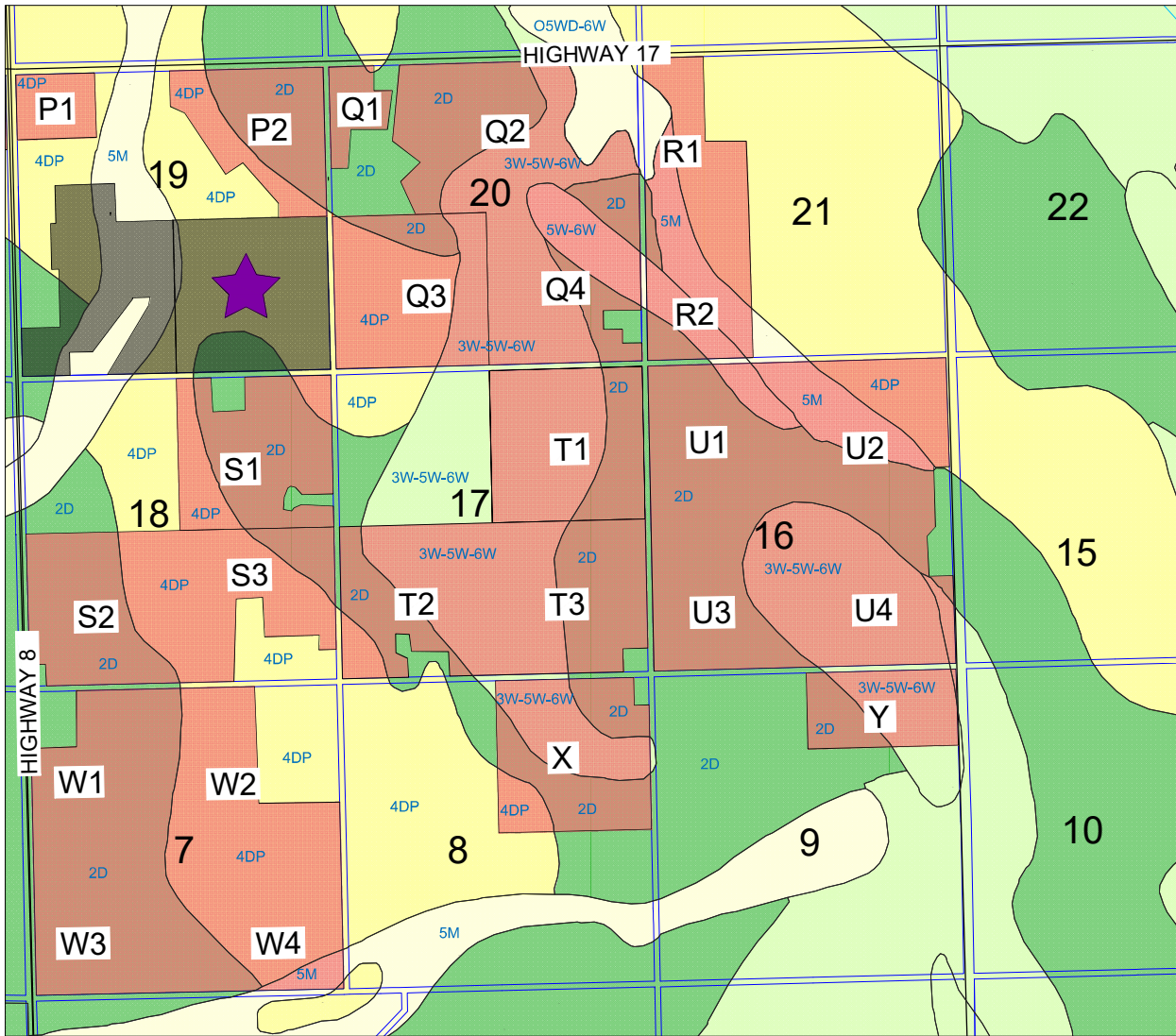

CLASS 2 SOIL	
CLASS 3 SOIL	
CLASS 4 SOIL	
CLASS 5 SOIL	
CLASS 6 SOIL	
CLASS 7 SOIL	
WATER	

LEGEND	
MUNICIPAL BORDER	
SUBJECT SITE	
EXISTING WATER FEATURE	
PROVINCIAL ROAD	
GOVERNMENT ROAD ALLOWANCE	
SPREADFIELD	
SUBJECT SITE	

Twp. 16

HIGHWAY 8

HIGHWAY 17

NO.	DATE	APP.	BY	DESCRIPTION
REVISIONS				

**PRELIMINARY**  
FOR REVIEW AND COMMENT ONLY

DESIGNED BY: KD  
 REVIEWED BY: DB  
 DRAWN BY: VP  
 PROJECT START DATE: DEC, 2023  
 PLOT SIZE: A1 (594x841)  
 SCALE: AS NOTED

PROJECT NAME:  
 NORWOOD COLONY  
 NEW SITE DEVELOPMENT  
 RM OF ST. ANDREWS

903 Rosser Ave.  
 Brandon, Manitoba  
 R7A 0R4  
 Tel: (204) 728-7364  
 Fax: (204) 728-4418

DRAWING TITLE:  
 SPREADFIELDS  
 VIEWPORT 6

PROJECT NUMBER: BMCE-23-001  
 DRAWING NO: SK-1F