

**REFERENCE DRAWINGS:**  
GENERAL

- 1-00193-DD-07331 0003/01 LANDS OF THE PROVINCE COVERED BY WATER REQUIRED FOR MAIN DIVERTING WORKS, POWER HOUSES, ETC.
- 1-00193-DE-07331-0002-001/00 LANDS REQUIRED FOR RIGHTS-OF-WAY AND TERMINAL STATIONS FOR LIMESTONE POWER DEVELOPMENT
- 1-00193-DE-07331-0001-001/00 SEVERANCE LINE FOR LIMESTONE POWER DEVELOPMENT
- 1-00193-DC-11800-0001-0001/00 SEVERANCE AREA LIMESTONE GENERATING STATION
- 00194-E-00203 /00 SEVERANCE LINE FOR LONG SPRUCE POWER DEVELOPMENT
- 00194-E-00208 1 OF 4/00 LANDS REQUIRED FOR RIGHTS-OF-WAY AND TERMINAL STATIONS FOR LONG SPRUCE POWER DEVELOPMENT
- 00194-E-00208 2 OF 4/00 LANDS REQUIRED FOR RIGHTS-OF-WAY AND TERMINAL STATIONS FOR LONG SPRUCE POWER DEVELOPMENT
- 00194-E-00208 3 OF 4/00 LANDS REQUIRED FOR RIGHTS-OF-WAY AND TERMINAL STATIONS FOR LONG SPRUCE POWER DEVELOPMENT

**NOTES:**

1. THE MAP BASE FOR THE DRAWINGS IS FROM THE 1:50 000 DIGITAL NATIONAL TOPOGRAPHIC SERIES MAPS PRODUCED BY NATURAL RESOURCES CANADA.
2. SHORELINES AND WERE GENERATED FROM A DIGITAL ELEVATION MODEL COLLECTED FROM 1971 AND 1993 1:50 000 AERIAL PHOTOGRAPHY.
3. ALL CO-ORDINATES ARE ON THE U.T.M. GRID, ZONE 15, 1983 ADJUSTMENT.
4. LEGAL PLANS SHOWN ARE FOR REFERENCE PURPOSES ONLY AND MAY OR MAY NOT BE IN THEIR TRUE LOCATION.
5. THE TOWNSHIP FRAMEWORK ON THE DRAWINGS IS THEORETICAL AND WAS OBTAINED FROM LINNET GEOMATICS INTERNATIONAL INC.
6. THE LOCATION OF THE WATER POWER SEVERANCE LINE IS EITHER BASED ON OR CONTROLLED BY THE BOUNDARIES ESTABLISHED BY:
  - THE DOMINION GOVERNMENT SURVEY SYSTEM, OR BY;
  - LEGAL SURVEY PLANS ON RECORD IN THE PROVINCIAL LAND TITLES SYSTEM.

**LEGEND:**

- SEVERANCE LINE
- LONG SPRUCE SEVERANCE LINE
- LAKE / RIVER
- HIGHWAY / ROAD
- TRANSMISSION LINE
- 1971 SHORELINE
- 1993 SHORELINE
- RAPIDS

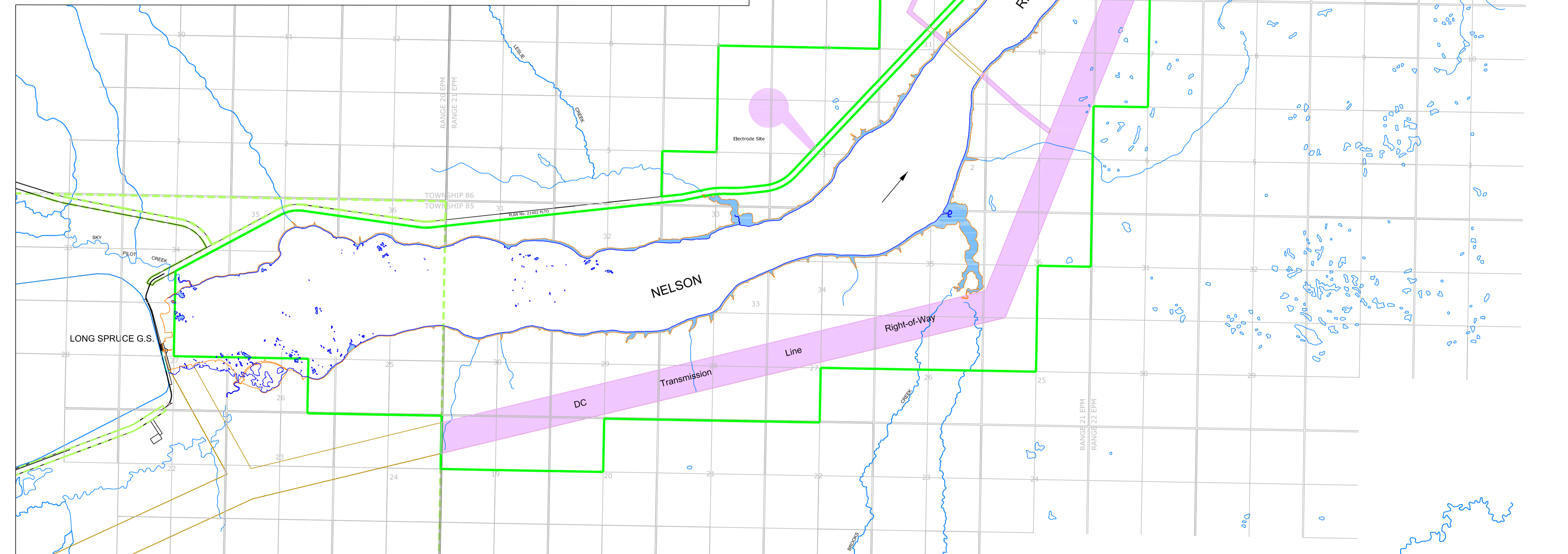

**NOTES:**

1. THIS PLAN HAS BEEN PREPARED PURSUANT TO SECTION 44(6) OF THE MANITOBA WATER POWER REGULATION 25/88R TO SHOW THE FOLLOWING LANDS:
  - (a) LANDS OF THE PROVINCE NOT COVERED BY WATER REQUIRED FOR MAIN DIVERTING WORKS, POWERHOUSES AND SIMILAR WORKS. 453.5 ACRES
  - (b) LANDS OF THE PROVINCE COVERED BY WATER REQUIRED FOR THE SAID PURPOSES. 262.8 ACRES
  - (c) LANDS OF THE PROVINCE REQUIRED ONLY TO BE FLOODED IN CONNECTION WITH THE STORAGE AND PONDAGE OF WATER. 498.8 ACRES
  - (d) LANDS OF THE PROVINCE REQUIRED FOR RIGHTS OF WAY FOR TRANSMISSION LINES, ETC. 2781.5 ACRES
  - (e) LANDS OF THE PROVINCE REQUIRED FOR SUBSTATIONS, DISTRIBUTION STATIONS, INCLUDING ELECTRODE SITE, ETC. 40.7 ACRES

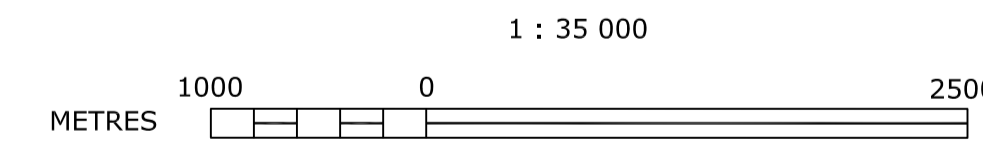

NOTED		NO.		DATE		REVISIONS		BY	CHKD.	APP.
CIVIL										
GEOTECHNICAL										
ELECTRICAL										
F.P. ENGINEER										
MEDICAL										
DISTRIBUTION										
PROJECT										
CONSTRUCTION										
MANAGER										

MANITOBA HYDRO  
LIMESTONE GENERATING STATION  
SEVERANCE LINE AND  
LANDS REQUIRED FOR FLOODING  
AND OTHER PURPOSES

SCALE: 1:35000  
DATE: 2012/08/28

1-00193-PE-07311-0001 0001 00